

# LAUFEN

Bathroom Culture since 1892  [www.laufen.com](http://www.laufen.com)

## Freestanding Bathubs



# Basic Composition

*Marbond (glossy)*

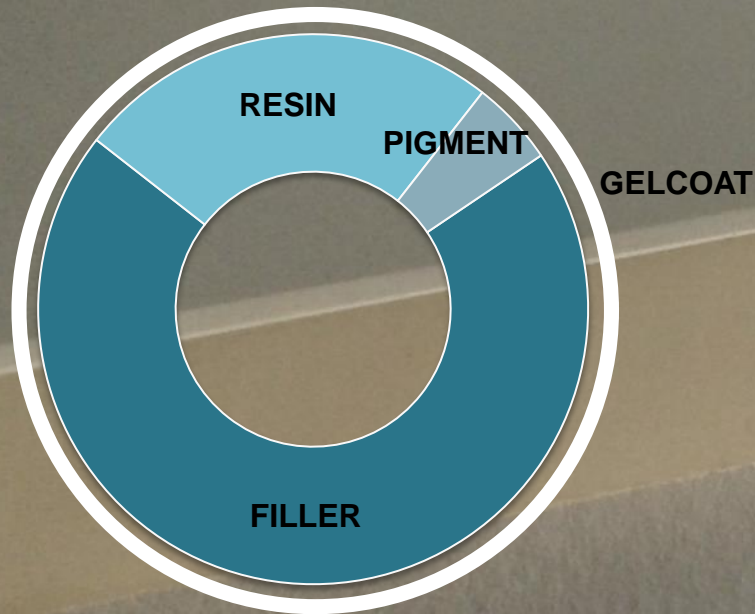

*Sentec (matt)*

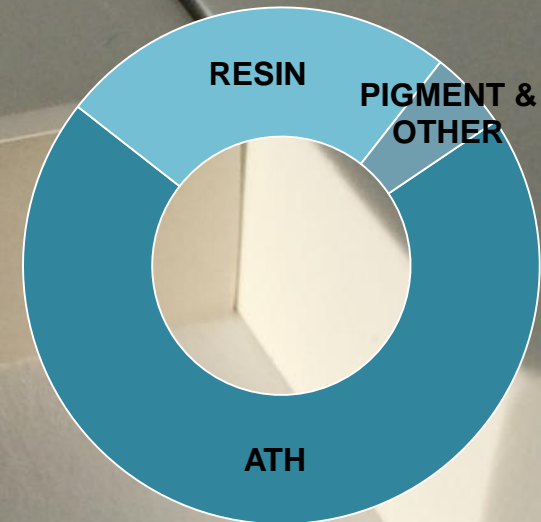

## Gel Coat or Cultured Marble

- Coating → Gel Coat (polyester pure resin with UV protection)
- Filler → Combination of different minerals
- Base resin → polyester resin

## Solid Surface

- Filler → ATH (aluminum trihydrate) with fire-retardant properties
- Base resin → can be acrylic, hybrid or polyester)
- Pigments and minerals → giving the color and texture

# SENTEC – SOLID SURFACE



# Ambient Pictures:



# Ambient Pictures:



# VAL 160x75cm

Freestanding oval shaped bathtub

Dimension: 1600 x 750 x 520 mm  
Material: Sentec (solid surface)  
Article code: 2.3028.2.000.000.1  
Colour: white matt

Matching with the thin rim of the SaphirKeramic pieces the bathtub model will complete the total bathroom concept.

- Integrated overflow in cast side wall
- centre outlet with chrome push opening
- small rim, due to one shot casting process
- less in weight
- with integrated feet and siphon
- for a comfortable entry with low total height the siphon will be installed in the floor

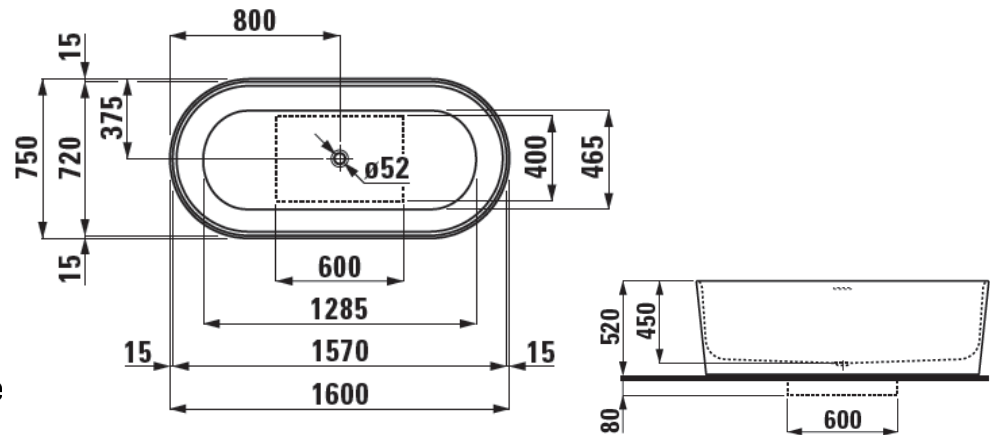

# INO 170x75cm

Freestanding oval shaped bathtub without head rest

Dimension: 1700 x 750 x 520 mm  
Material: Sentec (solid surface)  
Article code: 2.3130.2.000.000.1  
Colour: white matt

The smaller model completes our range of solid surface models.

Due to its thin walls and its smart shape it matches with all SaphirKeramic products, but can be combined also with other collections.

- with integrated casted overflow
- centre outlet with push opening
- small rim due to one shot casting process
- less in weight
- with integrated feet and siphon
- no hinge solution -> siliconed to the floor
- the siphon installation requests a hole in the floor.

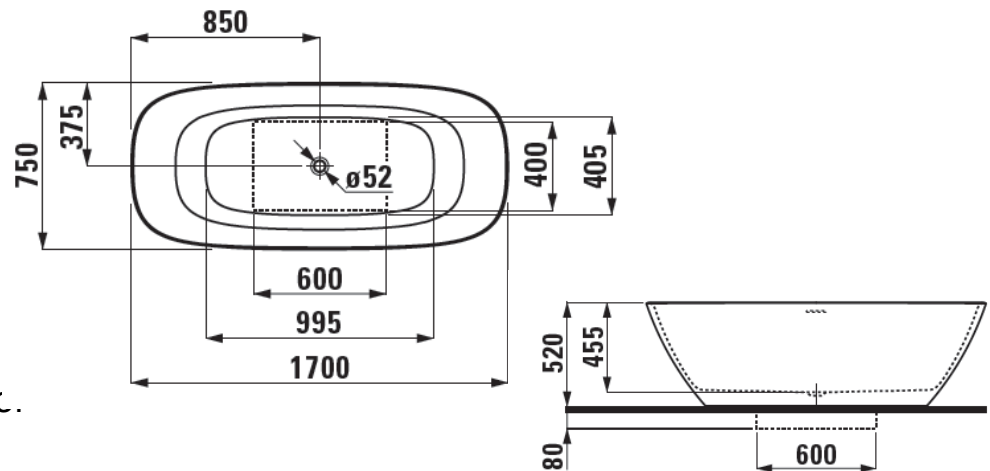

# Kartell 171x81cm

Freestanding oval asymmetric shaped bathtub

Dimension: 1715 x 814 x 520 mm  
Material: Sentec (solid surface)  
Article code: 2.2633.2.000.000.1  
Colour: white matt



Matching with the thin rim of the SaphirKeramic pieces the bathtub model will complete the total bathroom concept.

- overflow, integrated in cast side wall
- centre outlet with chrome push opening
- small rim, due to one shot casting process
- less in weight
- with integrated feet and siphon
- for a comfortable entry with low total height the siphon will be installed in the floor

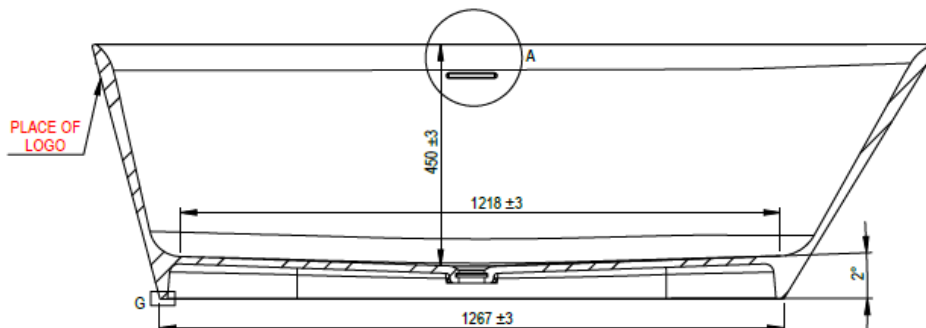



# INO 180x80cm

Freestanding oval shaped bathtub without head rest

Dimension: 1700 x 750 x 520 mm  
Material: Sentec (solid surface)  
Article code: 2.3130.2.000.000.1  
Colour: white matt



The smaller model completes our range of solid surface models.

Due to its thin walls and its smart shape it matches with all SaphirKeramic products, but can be combined also with other collections.

- with integrated casted overflow
- centre outlet with push opening
- small rim due to one shot casting process
- less in weight
- with integrated feet and siphon
- no hinge solution -> siliconed to the floor
- headrest at one side
- the siphon installation requests a hole in the floor

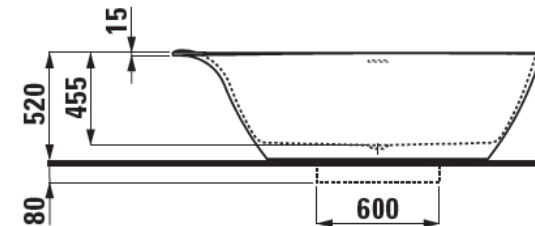
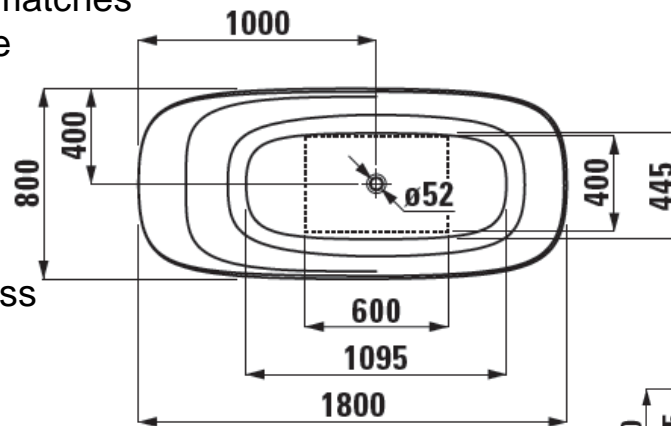

**LAUFEN**

Bathroom Culture since 1892  [www.laufen.com](http://www.laufen.com)

# MARBOND – GEL COAT:



# PRO 165x75 cm

Freestanding oval/round shaped

Dimension: 1650 x 750 x 550 mm

Material: Marbond (Gel Coat)

Article code: 2.3995.2.000.000.1

Colour: white glossy



Design is following the PRO range and is the perfect solution for high end bathrooms with an affordable freestanding bathtubs.

Due to its thin walls and its smart shape it matches with all SaphirKeramic products, but can be combined also with other collections.

- with integrated casted overflow
- With click-clack waste and chrome cover
- small rim due to one shot casting process
- Flexible pipe for water outlet included (1m)
- with integrated feet and siphon
- no hinge solution -> siliconed to the floor
- the siphon installation requests a hole in the floor

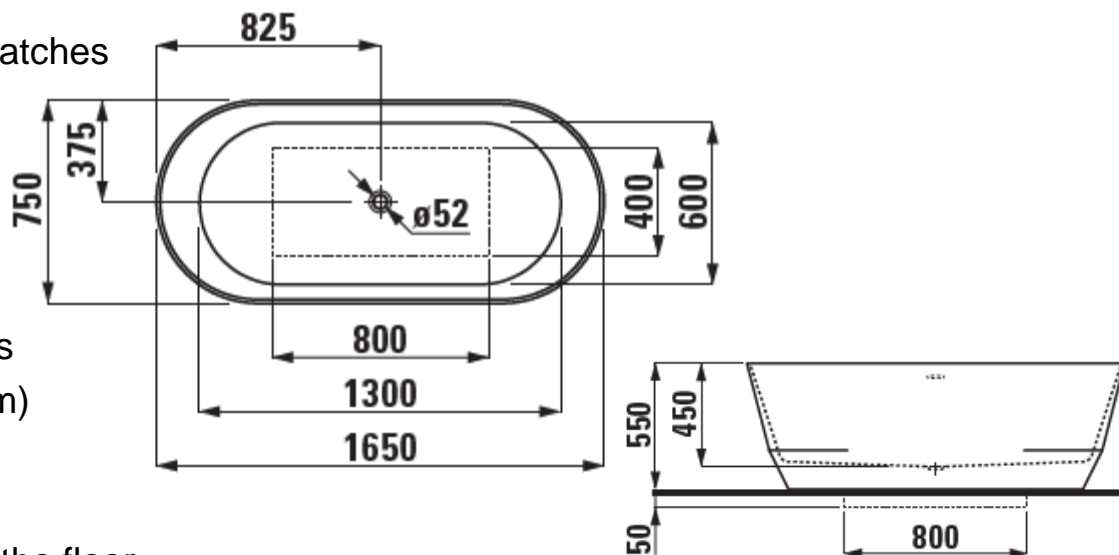

LAUFEN

Bathroom Culture since 1892  www.laufen.com

# Production process:

## Casting – Mold Preparation



# Production process:

## Casting



Caster Preparation



Casting Plates



Casting Bathtub



# Production process:

## Curing



# Production process:

## Assembling



# Production process:

## Finishing – Grinding and Polishing





# Production process:

## Logo Printing

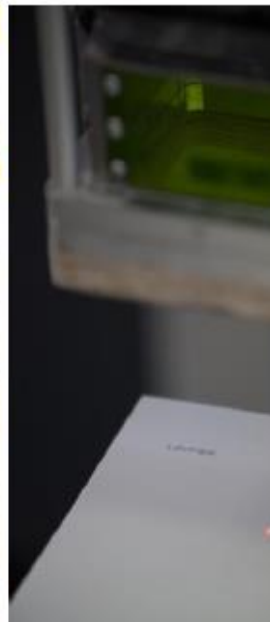

# Production process:

## Packaging and Palletization

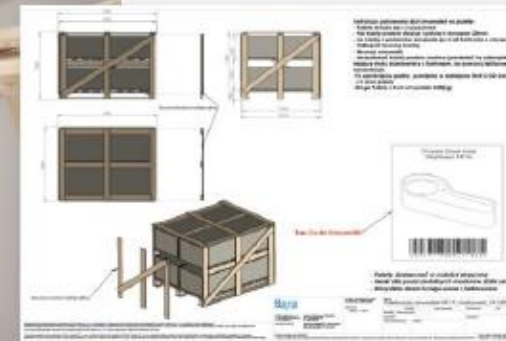

# Production process:

## Packaging and Palletization



# Cleaning & Maintenance

## Daily use

(cosmetics, coffee, cigarette, etc)

## „First aid” steps

- > wipe up stain
- > rinse with warm water
- > water with soap - hand wash
- > water+soap+scotch brite hand polishing



# Cleaning & Maintenance



## Cigarette Test

Test conducted with a solidsurface sample.

Burn mark will go away with soft scotch brite and soap, or a gentle cleaning paste.



# Cleaning & Maintenance



## Reparation (polishing machine)

In case the burn gets deeper into material –  
use polishing machine.

- if the burned spots remain it can be removed  
with electrical polishing machine with 400 grain  
sandpaper and sponge of 500 grain.

# Cleaning & Maintenance

## Cleaning

- clean the surface with a sponge or soft cotton cloth and some antistatic cleaning agents
- treat calcified surfaces with lime scale solvents and a soft sponge or cloth
- remove tenacious stains with liquid cleaning agents, e.g. dish detergents or soap
- absolutely abstain from detergents containing acids or sanding particles, like CIF scouring agent
- do not use micro fibre clothes, because the lime scale will remain in the cloth and may lead to scratches
- aggressive liquids as tea, coffee, nail polish, nail polish remover, hair colourings will leave visible stains, if the liquid appears for longer moments; removable only by abrasive papers
- liquids like nail polish remover

## Maintenance

- visible stains, e.g. burned rings of cigarettes, cracks or scratches can be removed by sand paper
- always sand a wider area as the effected
- stronger damages , cracks and stains should be treated with a repair paste by a qualified specialist
- deep impacts need to be sanded smooth , cleaned and filled up with the repair paste, after hardening process the repaired place should be sanded with different strong sand papers to a smooth surface

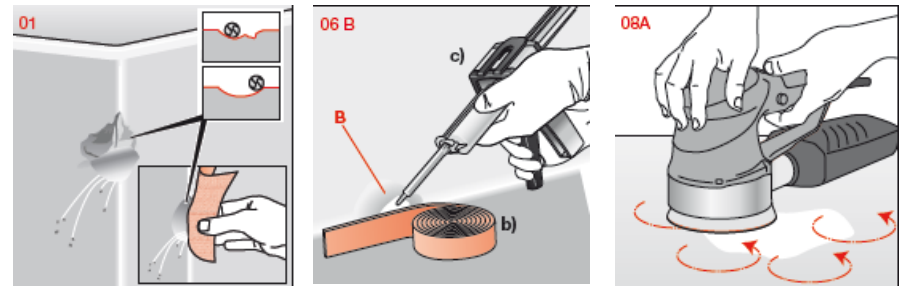

# LAUFEN

Bathroom Culture since 1892  [www.laufen.com](http://www.laufen.com)